

QCI

4G Connected Cam

User Manual

Copyright

Copyright 2015 BenQ Corporation. All rights reserved. No part of this publication may be reproduced, transmitted, transcribed, stored in a retrieval system or translated into any language or computer language, in any form or by any means, electronic, mechanical, magnetic, optical, chemical, manual or otherwise, without the prior written permission of BenQ Corporation.

Apple and the Apple logo are trademarks of Apple Inc., registered in the U.S. and other countries. App Store is a service mark of Apple Inc.

Android™, Google™, Google Play™, YouTube and other marks are trademarks of Google Inc.

All other logos, products, or company names mentioned in this manual are the registered trademarks or copyrights of their respective companies, and are used for informational purposes only.

Disclaimer

BenQ Corporation makes no representations or warranties, either expressed or implied, with respect to the contents hereof and specifically disclaims any warranties, merchantability or fitness for any particular purpose. Further, BenQ Corporation reserves the right to revise this publication and to make changes from time to time in the contents hereof without obligation of BenQ Corporation to notify any person of such revision or changes.

About this user manual

- Information contained in this user manual is correct at the time of release and subject to change without notice. Visit your local BenQ website from <http://www.BenQ.com> to download the latest version of this manual.
- Screen images and icons in this manual are simulated for illustrative purposes only. Actual displays may vary.
- In this User Manual, the following graphic symbols and texts are used to alert you to important information. Make sure you have read all the notes and warnings mentioned in this user manual.



Note: Useful tips or additional information that help you get better use of this device.



Warning: Instructions that must be followed. Failure to observe can cause damages to this device, or result in personal injuries.

Limit of Liability

All contents and services accessible through this device belong to third parties and are protected by the laws on copyright, patents, trademarks and/or other intellectual property laws. These contents and services are provided solely for your personal use and not for commercial use. You cannot use them without the explicit permission from the content owner or service provider. Without limiting the foregoing, except with the express authorization of the content owner or of the supplier of the services concerned, you are forbidden to modify, copy, republish, transfer, distribute, transmit, translate, sell, exploit or create derivatives, in any manner and on any medium, regardless of the content or services displayed by the intermediary of this device.

BenQ is not responsible for the content of the websites or of similar resources, which are maintained and controlled by third parties, that may be linked from this product. Providing links to those websites or to similar resources does not mean that BenQ makes any warranty or representation to their content by expression or by implication.

Any third party content or service preinstalled in this product is provided “as is”. BenQ does not, by expression or by implication, make any warrant to the content or to the services provided by third parties. BenQ does not warrant or guarantee that the content or services provided by third parties are accurate, effective, most up-to-date, legal, or complete. Under no circumstances shall BenQ be liable for the content or services provided by third parties including their negligence.

Services provided by third parties may be terminated temporarily or permanently. BenQ does not warrant or guarantee that any content or services provided by third parties are in good condition at any time, and is not liable for the termination of the said content and services.

In addition, BenQ is not involved in any transactions you conduct in the websites or similar resources maintained by third parties.

You should contact the content or service providers for any questions, concerns, or disputes.



The availability and performance of 4G LTE services depend on some factors, such as the 4G LTE coverage of your mobile service provider, your 4G LTE subscription plan, and your distance to a 4G LTE base station.

BenQ ecoFACTS

BenQ has been dedicated to the design and development of greener product as part of its aspiration to realize the ideal of the “Bringing Enjoyment ‘N Quality to Life” corporate vision with the ultimate goal to achieve a low-carbon society. Besides meeting international regulatory requirement and standards pertaining to environmental management, BenQ has spared no efforts in pushing our initiatives further to incorporate life cycle design in the aspects of material selection, manufacturing, packaging, transportation, using and disposal of the products. BenQ ecoFACTS label lists key eco-friendly design highlights of each product, hoping to ensure that consumers make informed green choices at purchase. Check out BenQ’s CSR Website at <http://csr.BenQ.com/> for more details on BenQ’s environmental commitments and achievements.



Table of contents

Important safety information	8
Battery usage	9
Safety instructions for underwater use	9
WEEE	10
Get started.....	10
Package contents	11
Overview	12
Front view.....	12
Rear view	12
Remove the back cover	13
Insert a nano-SIM card	13
To remove the nano-SIM card.....	13
Install the battery.....	14
To remove the battery	14
Install the back cover.....	15
Insert a microSD card (optional).....	15
Charge your camera	16
Assemble the waterproof case.....	17
Place anti-fog desiccants	18
Assemble the swivel T-Tip.....	19
A. Use with the waterproof case	19
B. Use with the vest holder	20
Replace the T-Tip adapter.....	21
Attach the T-Tip converter	22
Use your 4G Connected Cam.....	23
Turn on/off the power	23
Identify the OLED screen	23
Identify the LED indicators	25
Change modes.....	26
Set the date and time	26
Take photos.....	27
Take a single photo.....	27
Take continuous photos (burst mode)	28
Take photos using the self-timer	29
Record videos	30

Record a video.....	30
Record time-lapse videos.....	30
Live stream videos to YouTube.....	32
Manage photos and videos.....	32
Control your 4G Connected Cam.....	33
Use the Live-view RC watch	33
Overview.....	33
Charge the battery.....	33
Learn the basics	34
Set the date and time	34
Pair.....	35
Live view.....	37
Use the BenQ 4G Live Cam app	37
Features.....	37
Operating system requirements.....	38
Install the app	38
Set up the app.....	38
Initiate the app	39
Main screen overview	40
Set up your account to live stream to YouTube.....	41
Read your messages	41
Take photos.....	42
Record videos.....	42
Live stream videos to YouTube.....	43
Share live streaming videos.....	44
Replay live streaming videos.....	44
Manage photos and videos.....	45
Set up your camera.....	45
Change the WLAN password.....	46
Transfer camera files to a computer	46
Set up your 4G Connected Cam	47
Network.....	47
Roam	47
GPS	48
Video resolution.....	49
Photo resolution.....	49
Volume.....	50
Brightness	50

Auto power off	50
Orientation	51
Loop.....	51
Delete.....	52
Format.....	52
Update your camera	53
Password	53
Reset your camera	54
Check your camera's firmware version	54
Set up the Live-view RC watch.....	55
Stopwatch.....	55
Countdown timer.....	56
Alarm clock.....	56
Auto power off	56
Sound.....	57
Brightness	57
Troubleshoot	58
Power/battery	58
Nano-SIM card	58
Pair	59
Live streaming	60
Appendix	61
Specifications	61
RF exposure.....	62
CE SAR compliance	62
Caution	62
Limit your exposure to radio frequency (RF)	62
Declaration of Conformity.....	63

Important safety information



Read the safety information carefully before using your 4G Connected Cam (hereinafter called the “camera”). Failure to observe these instructions may result in damage to, or loss of, personal property, bodily injury, or even death.

- Do not place this camera under direct sunlight or near heat sources, such as in a closed car under sunlight or near a stove. The outer casing of this camera may become deformed and the sophisticated components inside may become damaged due to excessive heat.
- Do not use this camera without the waterproof case near water, in the rain or allow any liquid to get inside this camera. Water and moisture may cause short-circuit to the electronic components and lead to a malfunction.
- Do not use this camera near strong electromagnetic sources, such as a microwave oven. The electromagnetic interference may cause this camera to malfunction.
- Do not drop or apply shock/vibration to this camera. Strong impacts may damage the components inside.
- Do not use an unknown power adapter/battery other than the one supplied with this camera. Connecting this camera to an unknown power adapter is very dangerous and may lead to fire or explosion.
- Do not cut, bend, modify, place heavy objects, or step on the cable of the power adapter. Otherwise the external insulation may be damaged and result in short-circuit or fire.
- If there are strange odors or heat emitting from this camera or any signs of malfunction, disconnect this camera from the power immediately and contact your BenQ dealer for an inspection or service.
- If a foreign substance or water gets in this camera, turn the power off immediately and disconnect the power adapter. Contact your BenQ dealer to arrange a service.
- Do not attempt to disassemble or modify this camera. There are no user serviceable parts inside this camera, and unauthorized modifications will cause the warranty to void.
- Use this camera in environmental temperatures between 0 °C to 35 °C.
- Keep good ventilation during charging. Do not cover the power adapter with paper or objects that will reduce cooling.
- Connect the power adapter to a proper electrical outlet and power source. The voltage requirements are found on the product packaging.
- Do not use the power adapter in a highly humid environment.
- Never touch the power adapter with wet hands.
- Do not attempt to repair the power adapter. Replace the power adapter if it is damaged or exposed to excessive moisture. Contact your BenQ dealer or service center for help.
- The maximum operational ambient temperature (TMA) as specified by the manufacturer is 35 °C.

Battery usage

- Use only the supplied power adapter to charge the battery.
- Use only the supplied battery. Using an unapproved battery may cause your camera to explode and result in serious damage to your health or property.
- Do not disassemble the battery or throw the battery in fire as it may explode.
- Do not short-circuit the battery by connecting metal objects to the battery's positive (+) and negative (-) terminals. Doing so may cause the battery to generate heat and result in burns or property damage.
- Keep conductive material such as jewelry, keys or beaded chains away from exposed terminals to avoid short circuit.
- Incorrect use of the battery may cause a leak of chemicals or explosion. The leak of chemicals may harm the skin and erode the metal contacts. If any chemicals leak from the device, use a dry cloth to wipe it clean and contact your BenQ dealer or service center for help.

CAUTION:



- Risk of explosion if battery is replaced by an incorrect type.
 - Dispose of used batteries according to the instructions.
-

Safety instructions for underwater use

- To ensure the water resistance of your camera, all covers, including the cover for the charging port of the Live-view RC watch, must be firmly closed.
- Assemble the waterproof case to the camera and use desiccants before using the camera in cold, humid environments or going underwater. The camera itself and the battery are not water resistant.
- The desiccants provide limited anti-fog protection only and are not designed for long-term use. Replace the desiccants regularly.
- The waterproof case is in compliance with the Ingress Protection Marking ratings IPX8, meaning that, with the waterproof case assembled and locked, your camera is protected against low pressure water stream as well as against the effects of immersion for 60 minutes in fresh water up to 60 meter deep.
- Avoid opening or closing the waterproof case near the water's edge, such as sea, lake, beach, and so on. Do not open or close the waterproof case lock with wet hands or hands with sand or dust.
- Do not drop the waterproof case.
- Check the following items indoors before using the camera underwater:
 - Ensure that the waterproof case is assembled to the camera correctly and locked.
 - Clean the area surrounding the waterproof case lock. Ensure there is no dirt, sand or foreign objects near it.
 - Ensure that the waterproof case has no cracks or scratches. If you spot a leak, contact your BenQ dealer for an inspection or service.
- Place and use the waterproof case only at temperatures between 0 °C to 35 °C.

- Avoid bumping or knocking the waterproof case underwater, or the lock may be opened.
- Do not submerge the waterproof case to highly pressurized water. Use the waterproof case in fresh water and saltwater only. Any other liquids, such as cleaning substances or chemicals, must be wiped off immediately.
- Do not submerge the waterproof case in water deeper than 60 meters.
- Do not submerge the waterproof case in water for more than 60 minutes. After 60 minutes of use in water, allow the waterproof case to dry for at least 10 minutes.
- If water accidentally gets inside the camera while it is in water, bring the camera out of water immediately, and send it to the nearest service center.
- After using the waterproof case, perform the following operations:
 - Come ashore for 60 minutes.
 - Clean the waterproof case with running tap water. Do not use any soapy water, detergents or alcohol to clean the case.
 - Wipe off water drops on the waterproof case with a soft lint-free cloth. Be sure to wait until the waterproof case is completely dry before opening the waterproof case lock.
 - Remove the camera from the waterproof case, and rinse the waterproof case thoroughly with clean water. Wipe the waterproof case with a dry and clean lint-free cloth. Place the waterproof case in a well-ventilated place to dry naturally (do not place it under direct sunlight).

WEEE

Disposal of Waste Electrical and Electronic Equipment and/or Battery by users in private households in the European Union.

This symbol on the product or on the packaging indicates that this can not be disposed of as household waste. You must dispose of your waste equipment and/or battery by handing it over to the applicable take-back scheme for the recycling of electrical and electronic equipment and/or battery. For more information about recycling of this equipment and/or battery, please contact your city office, the shop where you purchased the equipment or your household waste disposal service. The recycling of materials will help to conserve natural resources and ensure that it is recycled in a manner that protects human health and environment.

Recycling information: See <http://www.benq.com/support/recycle> for details.

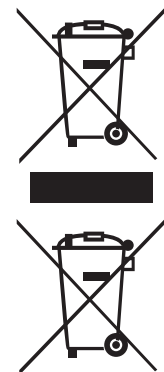

Get started

This 4G Connected Cam provides high speed data transmission and wider bandwidth for multimedia streaming needs and can be used when performing extreme sports.

Package contents

Check the sales package for the following items. If any item is missing or damaged, contact your place of purchase immediately.

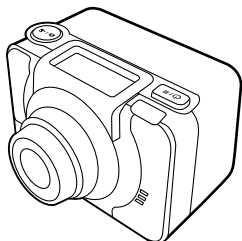

4G Connected Cam



Live-view RC watch

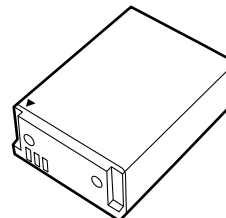

Li-ion battery

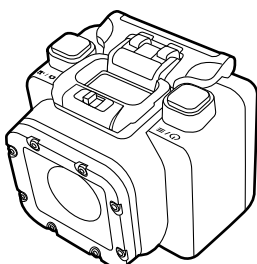

Waterproof case

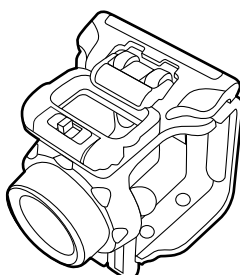

Vest holder

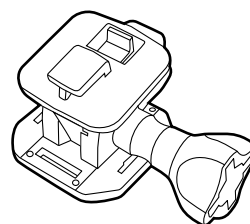

Swivel T-Tip

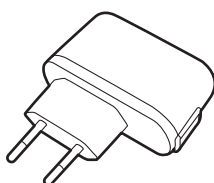

USB power adapter

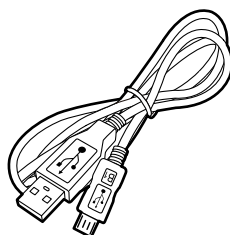

USB cable

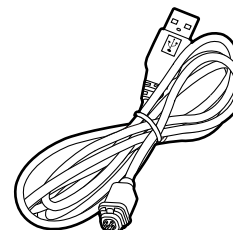

Watch charging cable

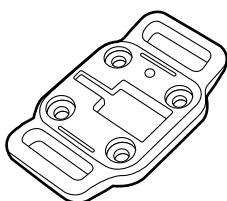

T-Tip adapter (already attached onto the waterproof case)

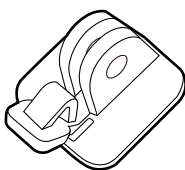

T-Tip converter

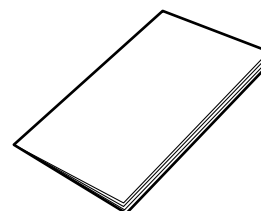

Quick Start Guide and documentation

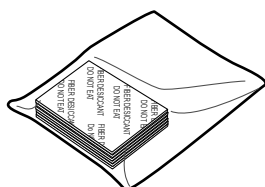

Anti-fog desiccant pack



Plug types vary by country/region.

Overview

Front view

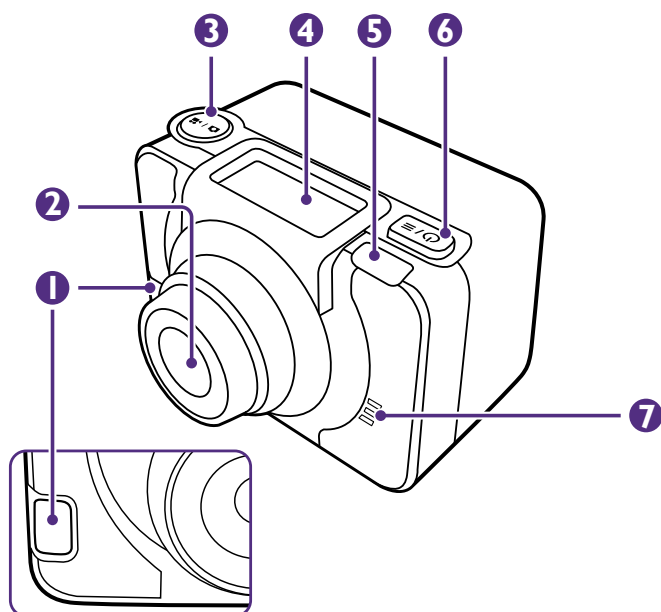

Close-up view

No. Item

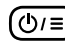
- | | |
|---|---|
| 1 | LED indicator 1 |
| 2 | Lens |
| 3 | SHUTTER button  |
| 4 | OLED screen |
| 5 | LED indicator 2 |
| 6 | POWER/MENU button  |
| 7 | Speaker |

Rear view

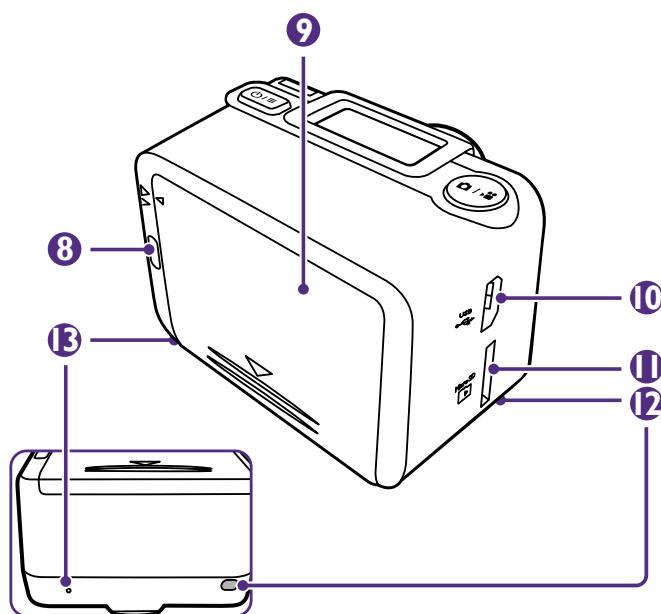

Bottom view

No. Item

- | | |
|----|-------------------|
| 8 | LED indicator 3 |
| 9 | Back cover |
| 10 | Micro USB port |
| 11 | MicroSD card slot |
| 12 | LED indicator 4 |
| 13 | Microphone |

Remove the back cover

Slide down to remove the back cover of your camera.

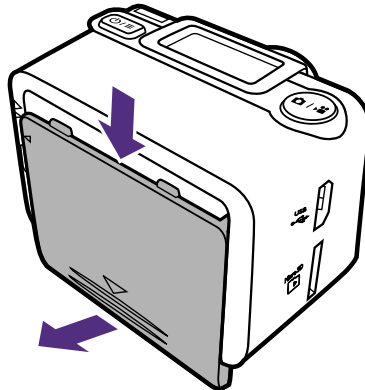

Insert a nano-SIM card



Do not use a micro-SIM card in this camera. Using incompatible SIM cards may damage the card or the camera.

Lift up the protective rubber flap **a**, and fully insert the nano-SIM card with the cut corner at the top right and its metal contacts facing down **b** until it clicks into place.

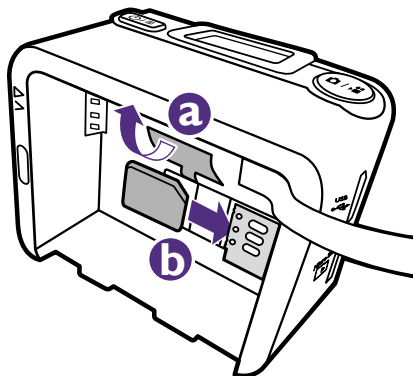

To remove the nano-SIM card

Push the nano-SIM card in **c** to release it from the card slot, and then pull out the nano-SIM card **d**.

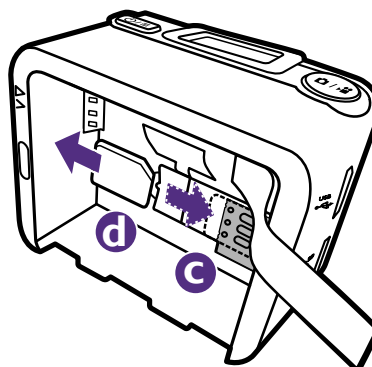

Install the battery

Align the mark on the battery with the one on the camera, and install the battery with the ribbon under it. Make sure the end of the ribbon is exposed.

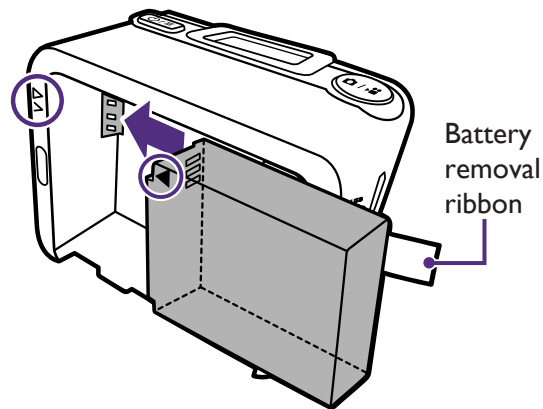

To remove the battery

Pull the battery removal ribbon to eject the battery **a**, and then take it out **b**.

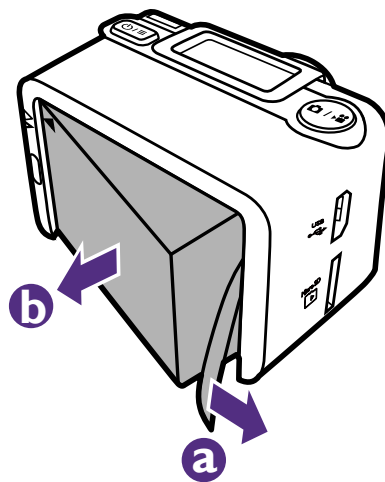

Install the back cover

Slide to install and lock the back cover into place.

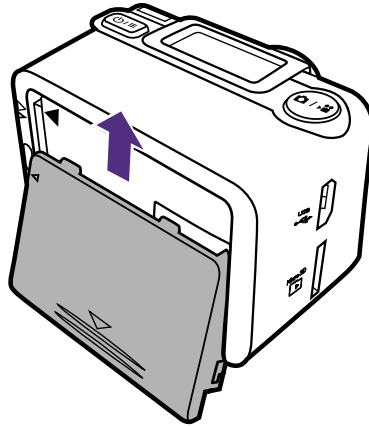

Insert a microSD card (optional)



- The camera supports microSD cards (formatted in FAT32 only) up to 64 GB in size.
- The microSD card is available only by separate purchase.

1. Align the microSD card with the mark next to the microSD card slot.
2. Fully insert the microSD card into the card slot until it clicks into place.

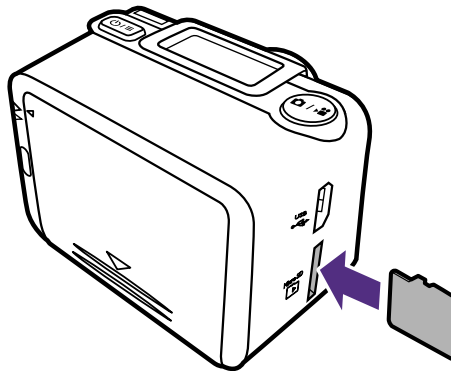

Your camera automatically selects the source for multimedia file storage. If you have inserted a microSD card into your camera, photos/videos captured will be stored in the microSD card storage. If no microSD card is inserted, photos/videos captured will be stored in your camera's internal storage (limit: approximately 2.4 GB). The actual storage space in your camera available for use depends on the amount of space the preloaded content takes.

Charge your camera



Use original approved accessories only.

1. With the battery installed in your camera, insert the smaller end of the USB cable into your camera's micro USB port.

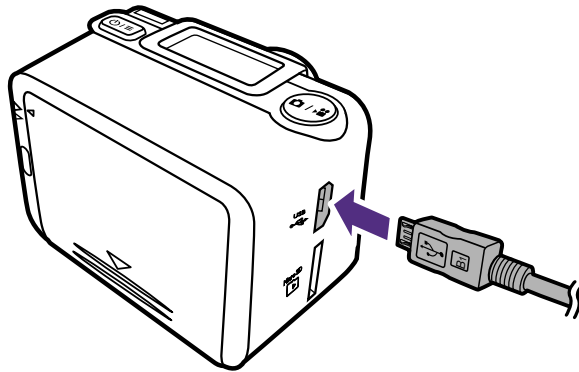

2. Insert the larger end of the USB cable into the USB power adapter.
3. Plug the USB power adapter into an electrical outlet to start charging. The LED indicator I lights up in solid red.

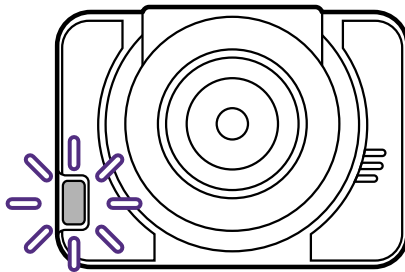

4. When charging is complete (approximately 3 hours), the LED indicator I goes out. Disconnect your camera and the USB power adapter.

Assemble the waterproof case

1. Place your camera inside the waterproof case **a**, and then close the waterproof cover **b**.

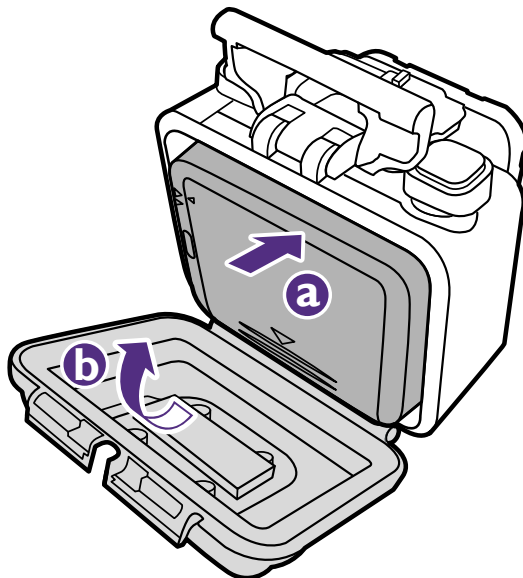

When placing the camera inside the waterproof case, ensure that the camera is perfectly aligned and evenly inserted.

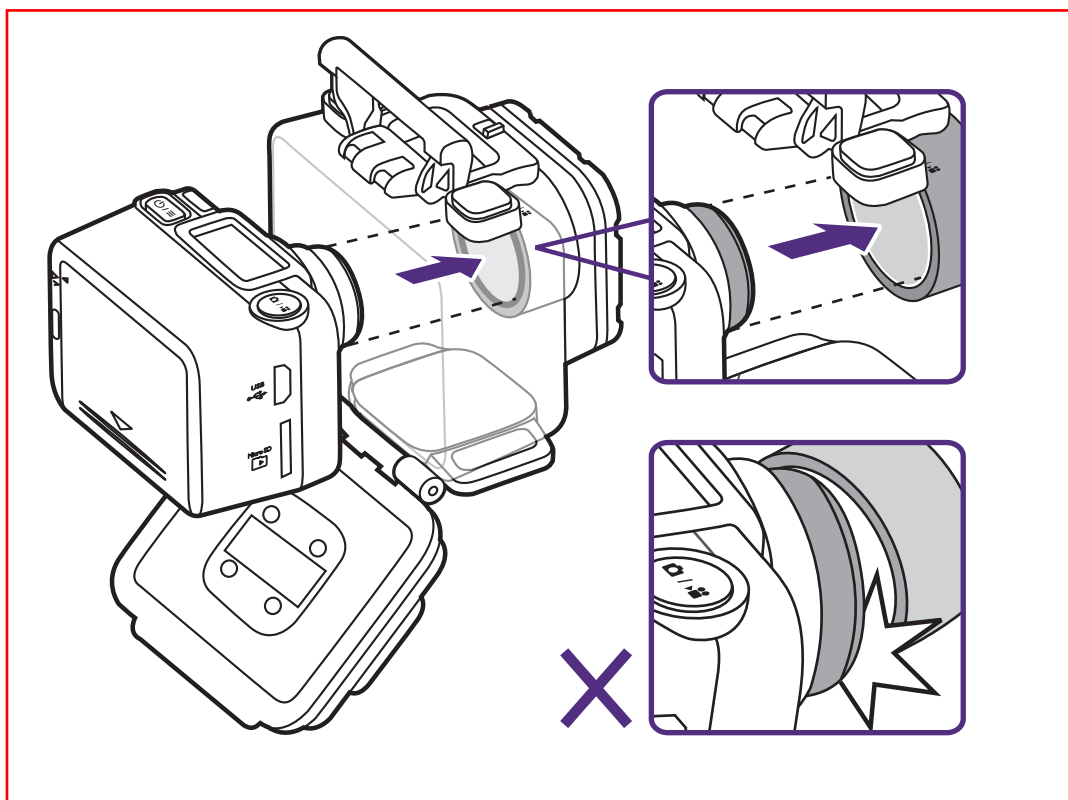

2. While pushing the waterproof cover **c**, simultaneously flip the latch **d** to lock the cover **e**.

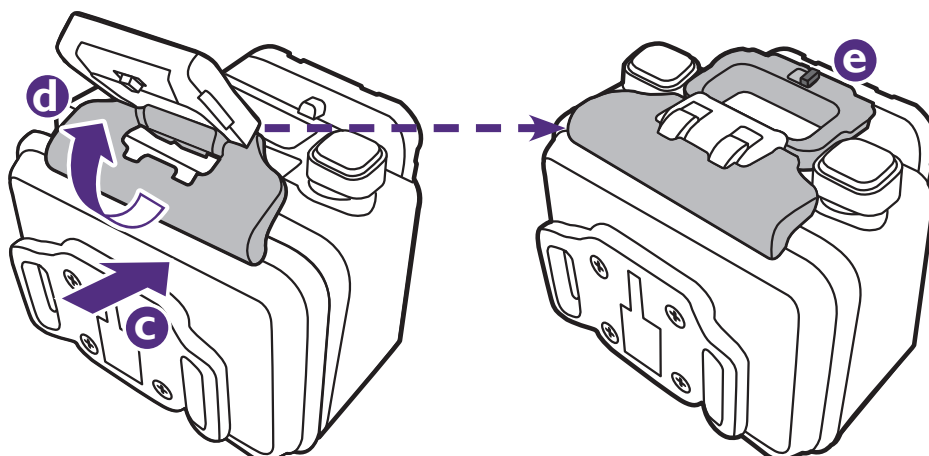

Place anti-fog desiccants

Placing anti-fog desiccants inside the waterproof case helps to absorb water and avoid fogging. Replace the desiccants after every three times of use, each use for about two hours.

Before using your camera under water or in a humid environment:

1. Place your camera (with the battery inserted), the waterproof case and the anti-fog desiccants into a drying cabinet for two hours.
2. Squirt toothpaste or anti-fog agents on the inside of the lens of the waterproof case, and rub it around with your finger or a soft cloth. Leave it dry for a few minutes.
3. Place your camera inside the waterproof case.
4. Place 3 anti-fog desiccants inside the waterproof case.

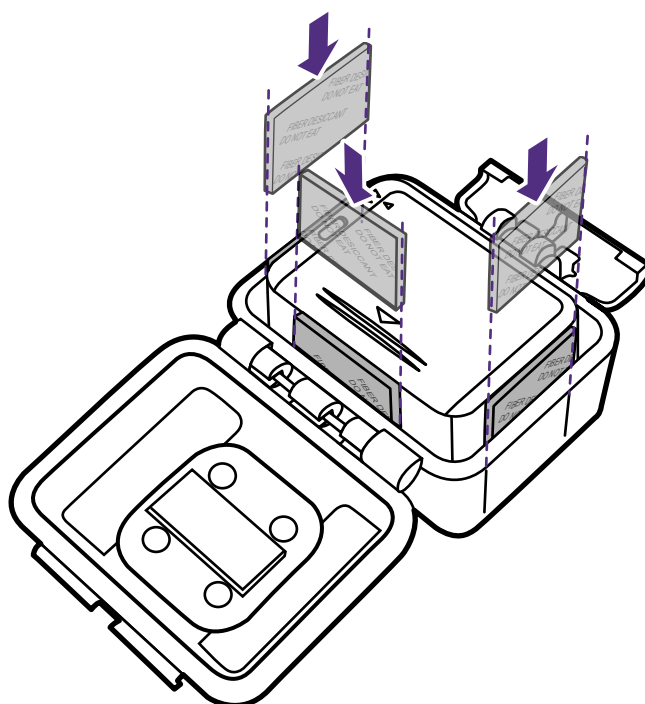

5. Close and lock the waterproof case immediately.

Assemble the swivel T-Tip

Attaching the swivel T-Tip allows you to use your camera with various mounts and accessories, and swivel your camera back and forth, depending on the angle you want.

A. Use with the waterproof case

1. Assemble the waterproof case to your camera.
2. Lock the swivel T-Tip to the waterproof case in the following order.

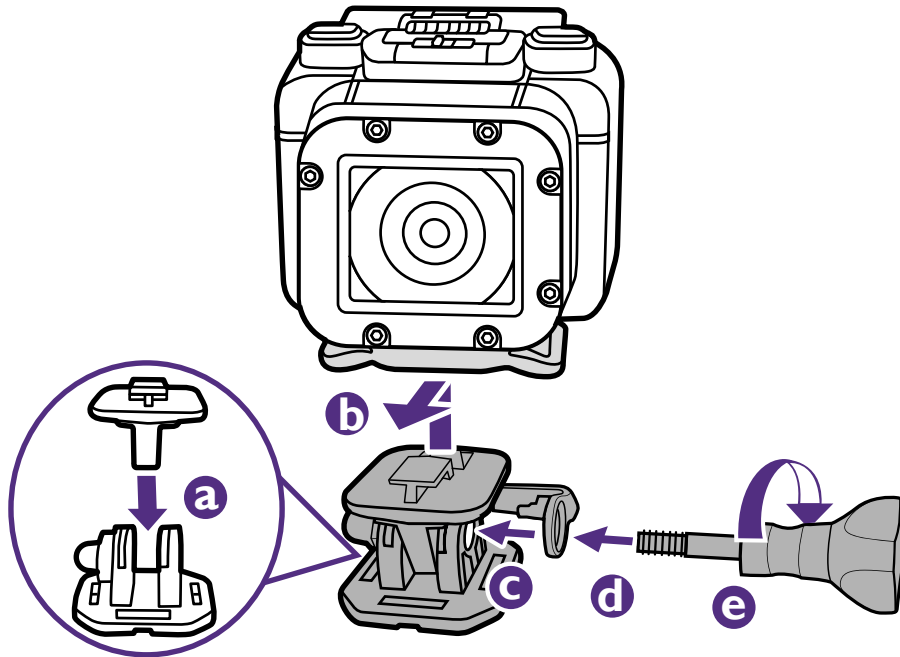

3. Slip in the lower part of the swivel T-Tip to lock onto the adhesive socket (purchase upon request).

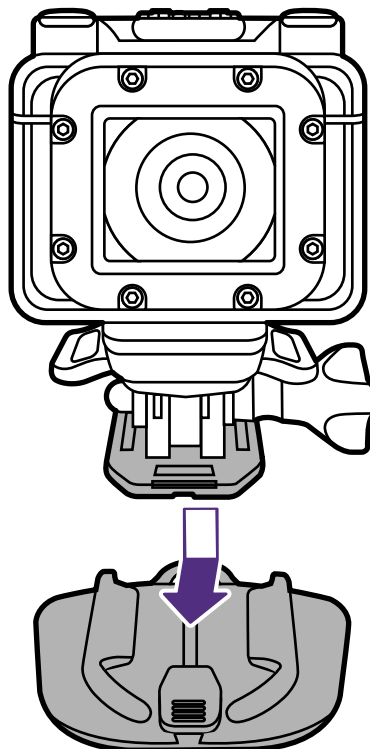

B. Use with the vest holder

- I. Place your camera inside the vest holder **a**, and then flip the latch over your camera **b**.

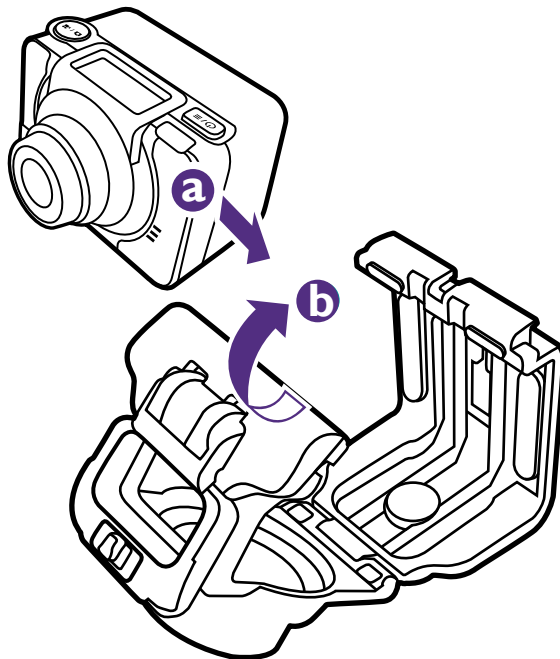

2. Flip down the latch **c** to lock the vest holder **d**.

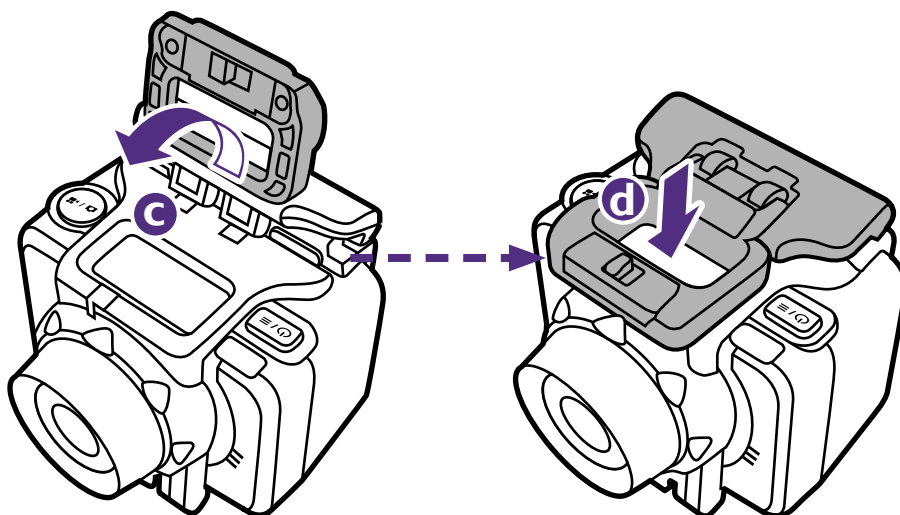

3. Lock the T-Tip adapter to the bottom of the vest holder.

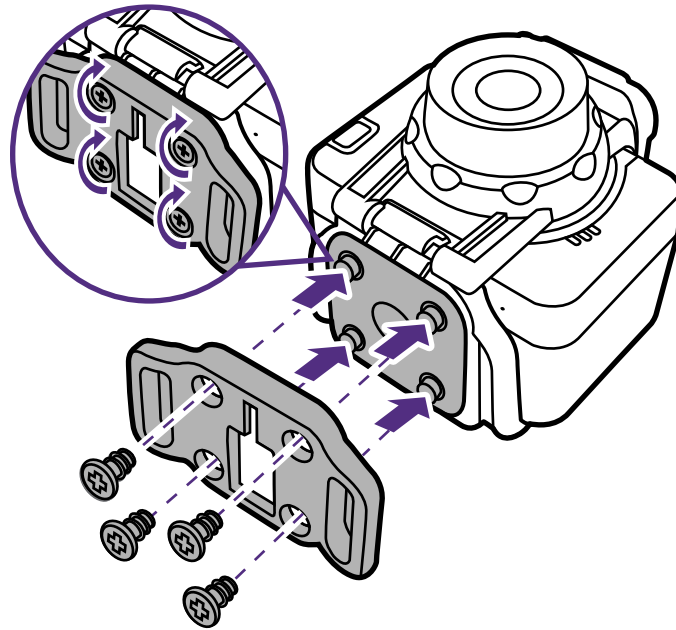

4. Follow steps 2-3 on from A to lock the swivel T-Tip to the vest holder and the adhesive socket (purchase upon request).

Replace the T-Tip adapter

Depending on the accessories and the angles you want to use with the camera, the T-Tip adapter may be detached and attached to the waterproof case or the vest holder.

To remove the T-Tip adapter, rotate the screws counterclockwise to unlock the adapter from the case or the holder.

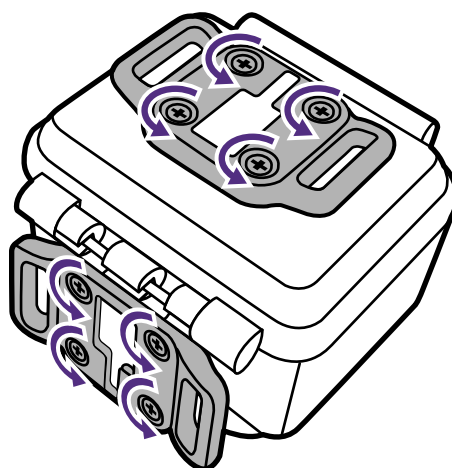

Attach the T-Tip converter

Use the T-Tip converter to connect your camera to screw-lock type accessories (separate purchase).

1. Place your camera inside the waterproof case or the vest holder.
2. Slip in to lock the T-Tip converter to the T-Tip adapter.

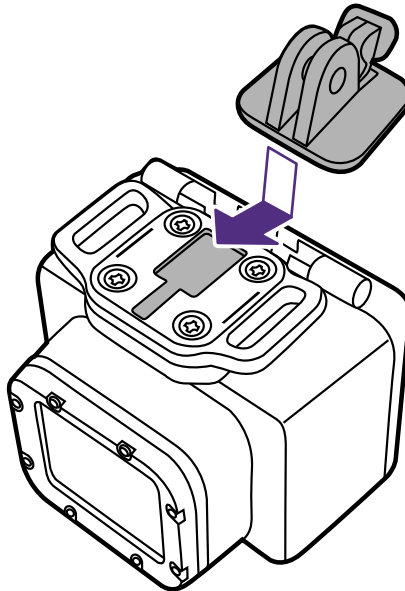

3. Attach the screw-lock type accessory.

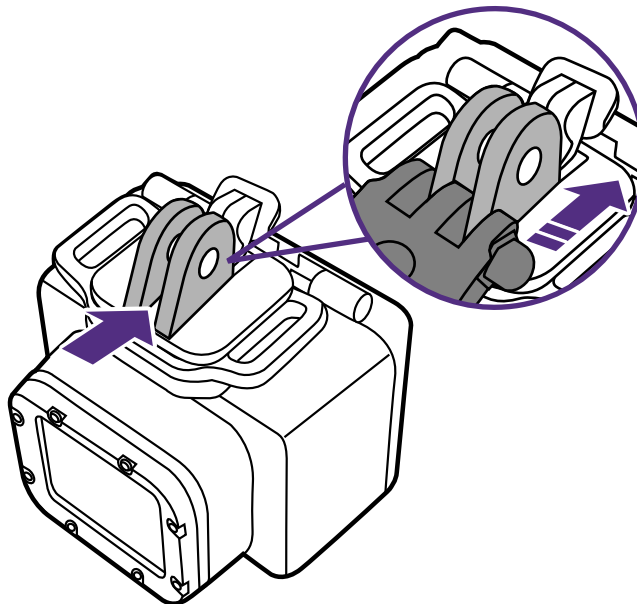

Use your 4G Connected Cam



A nano-SIM card is required to use cellular services when connecting to 4G LTE or 3G networks.

Turn on/off the power

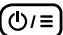
Press and hold .



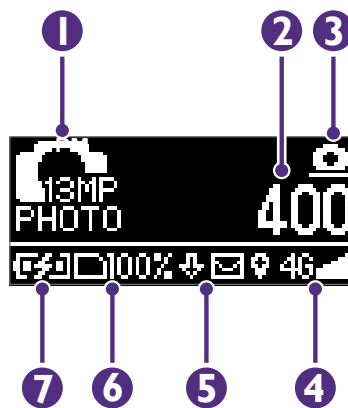





Identify the OLED screen



The icons shown in the screen above may vary depending on the mode your camera is in.

No. Meaning

Current mode:

-  /  : Video mode
-  /  /  : Photo mode
-  : Live streaming mode
-  : Pairing mode
-  : Settings mode



The numbers on the Video/Photo mode icons indicate current camera resolution. To adjust the settings, please refer to [“Set up your 4G Connected Cam” on page 47](#).

Identify the OLED screen (continued from the previous page)

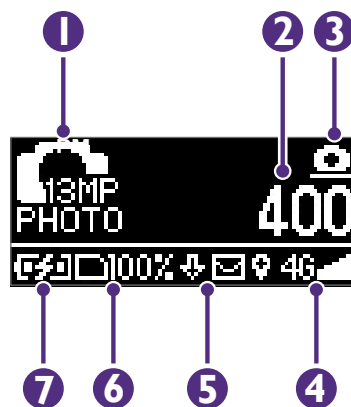

No.	Meaning
	<ul style="list-style-type: none"> • Video mode: Recording length of videos remaining
2	<ul style="list-style-type: none"> • Photo mode: Number of photos remaining • Live streaming mode: Uploading length of videos to live streaming • Pairing/Settings modes: N/A
3	Indicates screen orientation
	Network status icon:
4	<ul style="list-style-type: none"> • : Network strength • : 3G/4G network is connected • : Network is roaming
	Notification area:
5	<ul style="list-style-type: none"> • : A software update is available for download • : The software download is complete • : You have an SMS message • : Both software updates and SMS messages are available for download • : The GPS function is turned on • : Current location is positioned
	To read the SMS messages, use the BenQ 4G Live Cam app installed on your mobile device. For detailed instructions, please refer to “Read your messages” on page 41 .
	Storage space available in the following drives:
6	<ul style="list-style-type: none"> • : Internal • : MicroSD card
	Battery status icon:
7	<ul style="list-style-type: none"> • : Battery is empty • : Battery is charging • : Battery is fully charged

Identify the LED indicators

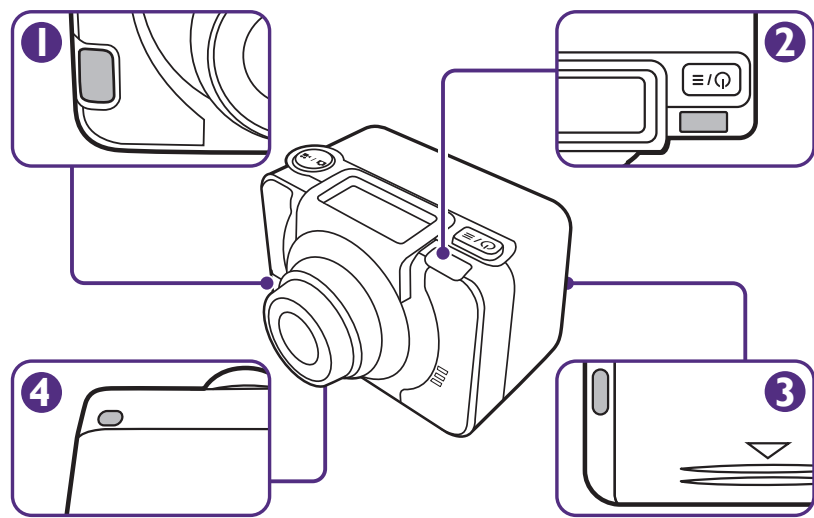

LED indicator	Behavior	Meaning
1	Solid red	The battery is charging.  After the battery is fully charged, the indicator goes out.
	Smart flash	Take photos using the self-timer.
	Flashing red every 3 seconds	The battery power is low.
2	Flashing green every 3 seconds	The camera is in standby mode.
234	Solid red for 1 second	The camera is starting up/shutting down.
	Flashing red 3 times in a row	The battery power is depleted and the camera cannot turn on.
1234	Flashing red 1 time only	Take single/multi photos.
	Flashing red every 1 second	Video recording is in progress.

Change modes

Press  to go through the following modes.

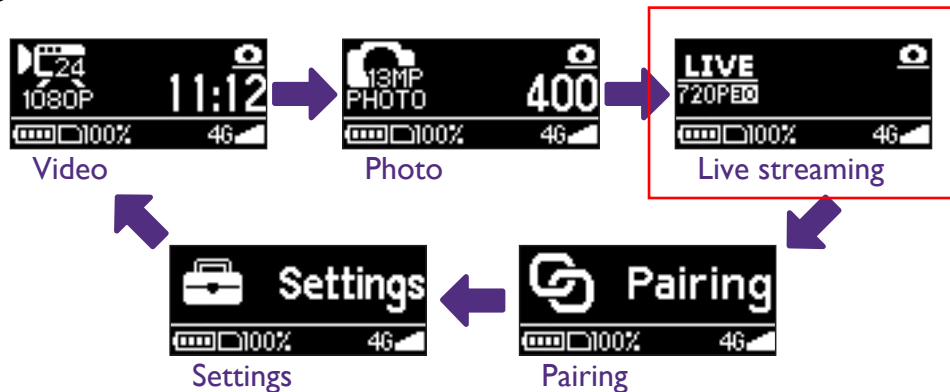

Set the date and time

1. Press  > the Settings mode > press .





2. Press  > **MORE** > press .



3. Press  > **TIME** > press .

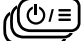



4. To use your mobile network as the time source, press  > **AUTO** > press .



To manually set current date and time, continue to the next step.

5. Press  > **MANUAL** > press .

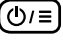

6. Press  to select the Year field, and press  repeatedly to adjust the value.
 Repeat this step to adjust month, day, hour and minute.



7. Press  > **OK** > press  to apply changes.

Take photos

- If you wish to preview the objects before taking photos, use the Live-view RC watch or the BenQ 4G Live Cam app installed on your mobile device. For detailed instructions, please refer to [“Control your 4G Connected Cam” on page 33](#).
- To view the photos taken, use the BenQ 4G Live Cam app installed on your mobile device or transfer files to your computer. For detailed instructions, please refer to [“Manage photos and videos” on page 45](#) or [“Transfer camera files to a computer” on page 46](#).

Take a single photo

Take a single photo at a time. This is also the default photo mode.

1. Press  > the Photo mode.



2. Press  to take a photo.

Take continuous photos (burst mode)

Quickly capture a number of consecutive shots.

1. Press  > the Settings mode > press .



2. Press  > **SETUP** > press .



3. Press  > **CAM MODE** > press .



4. Press  > **PHOTO** > press .



5. Press  > **BURST** > press .



6. Press  > **EXIT** > press .



Repeat this step to return to the first menu level.

7. Press  > the Photo mode.



8. Press  to take 20 photos continuously.

Take photos using the self-timer

1. Press  > the Settings mode > press .



2. Press  > **SETUP** > press .



3. Press  > **CAM MODE** > press .



4. Press  > **PHOTO** > press .



5. Press  > **TIMER** > press .



6. Press  > desired delay time > press .



7. Press  > **EXIT** > press .

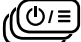

Repeat this step to return to the first menu level.

8. Press  > the Photo mode.



9. Press  to take a photo after the specified delay.

Record videos



- If you wish to preview the objects before recording videos, use the Live-view RC watch or the BenQ 4G Live Cam app installed on your mobile device. For detailed instructions, please refer to [“Control your 4G Connected Cam” on page 33](#).
- To watch the videos recorded, use the BenQ 4G Live Cam app installed on your mobile device or transfer files to your computer. For detailed instructions, please refer to [“Manage photos and videos” on page 32](#) or [“Transfer camera files to a computer” on page 46](#).

Record a video

Record videos at normal speed. This is also the default video mode.

1. Press  > the Video mode.



2. Press  to start recording. Elapsed time of recording will be shown on the screen.



3. You can use the Live-view RC watch to take still photos while recording a video (optional). Please refer to [“Use the Live-view RC watch” on page 33](#).
4. Press  again to stop recording.

Record time-lapse videos

Capture continuous shots at the preset interval time and save them into one video automatically. The recorded video is played back in fast motion, producing a time passage effect, such as traffic flow, sunrise/sunset, plant growth, etc.

1. Press  > the Settings mode > press .



2. Press  > **SETUP** > press .

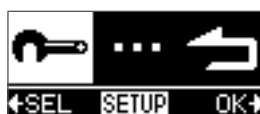

3. Press  > **CAM MODE** > press .



4. Press  > **VIDEO** > press .



5. Press  > **LAPSE** > press .



6. Press  > desired time interval > press .



7. Press  > **EXIT** > press .



Repeat this step to return to the first menu level.

8. Press  > the Video mode.



9. Press  to start/stop recording.

Live stream videos to YouTube

Before using this function for the first time, you must set up and log into your Google account using the BenQ 4G Live Cam app running from your mobile device. For detailed instructions, please refer to [“Use the BenQ 4G Live Cam app” on page 37](#).

To live stream a video to YouTube, you must enable network data connection, stay connected to the 3G/4G network, and have at least 100 MB of storage space available either on the camera or the microSD card for the camera, and ensure that the live stream lasts longer than 30 seconds. To ensure the optimal video quality, use a 4G network for live streaming.



Using mobile data connection may cause additional charges for data services. Contact your mobile service provider to check details of your data tariff plan.

1. Press  > the Live streaming mode.



2. Press  to start recording. Elapsed time and uploading megabytes since the live stream began will be shown on the screen.



3. Press  again to stop recording. The screen displays total live streaming time. A copy of this recording will be saved in the internal or microSD card drive.

Manage photos and videos

To view or share the photos and videos captured with your camera, use the BenQ 4G Live Cam app running from your mobile device, or transfer the files to your computer. For detailed instructions, please refer to [“Use the BenQ 4G Live Cam app” on page 37](#) and [“Transfer camera files to a computer” on page 46](#).

Control your 4G Connected Cam

Use the Live-view RC watch

Overview

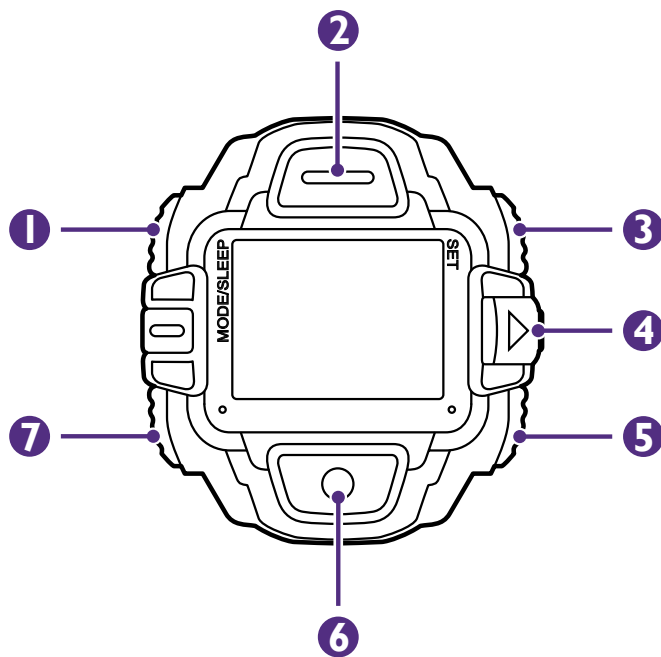

No.	Item
1	MODE/SLEEP
2	PHOTO
3	SET
4	Charging port
5	NEXT
6	VIDEO
7	PREV (Previous)



The Live-view RC watch hereinafter is called the “watch”.

Charge the battery

1. Press the cover lock **a** to release the protective cover.
2. Flip open the protective cover **b**, and insert the smaller end of the watch charging cable into your watch's charging port **c**.

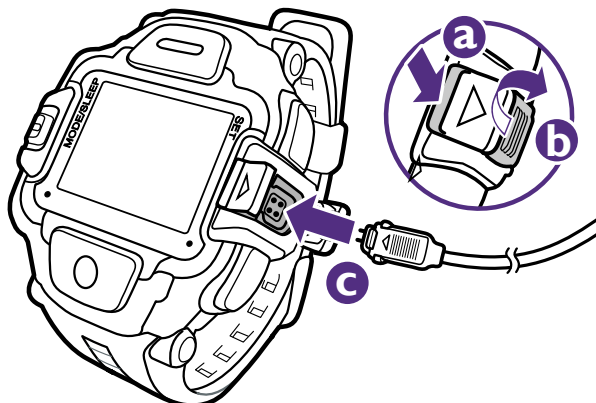

3. Insert the larger end of the watch charging cable into the USB power adapter.
4. Plug the USB power adapter into an electrical outlet to start charging.
5. When charging is complete (approximately 2 hours), the screen displays a “battery full” icon . Disconnect your watch and the USB power adapter.

Learn the basics

- To turn on the screen display, press any button.
- To select viewfinder or clock, press MODE/SLEEP repeatedly.
- When in clock mode, press PREV repeatedly to go through clock functions. For detailed instructions, please refer to [“Set up the Live-view RC watch” on page 55.](#)

Set the date and time

1. Press and hold SET until the hour starts to flash, indicating the date/time setting screen.

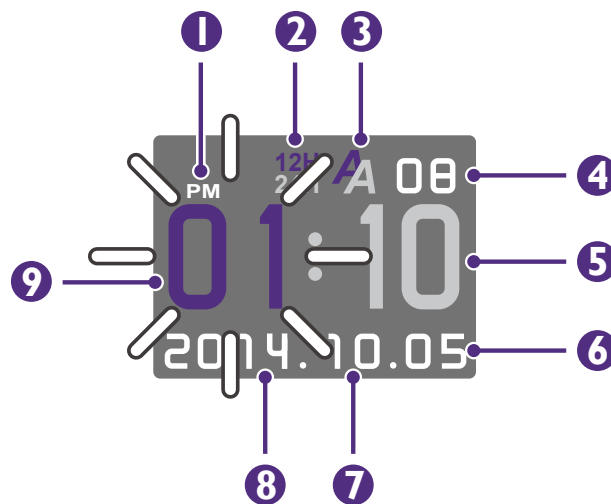

No.	Item
①	AM/PM
②	Time format
③	Clock display color
④	Second
⑤	Minute
⑥	Day
⑦	Month
⑧	Year
⑨	Hour

2. Press NEXT repeatedly to select the desired field.

3. Use VIDEO or PHOTO to adjust the value, set time format or color of the clock display.
4. Press SET to apply changes and exit the date/time setting screen.

Pair



The network data of your camera is turned on by default. If the data is turned off, please refer to [“Network” on page 47](#) to enable network data transmission before pairing.

1. Press > the Pairing mode > press .



2. Press > **WATCH** > press .



Your camera and watch are already paired from the factory. If pairing does not start after switching camera pairing to watch or if you wish to pair a new watch, proceed with the following steps.

A. On your camera

1. Press > the Settings mode > press .



2. Press > **SETUP** > press .



3. Press > **CONNECT** > press . The camera is ready for pairing.



B. On your watch

1. Press MODE/SLEEP to switch to viewfinder mode.



2. Press and hold SET to enter the SET menu.

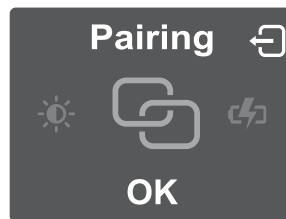

3. Press NEXT repeatedly to display the **Pairing** screen, and then press VIDEO. Press VIDEO again to delete current pairing.

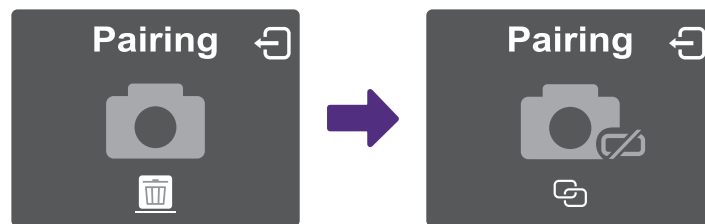

4. Press VIDEO to start a new pairing.

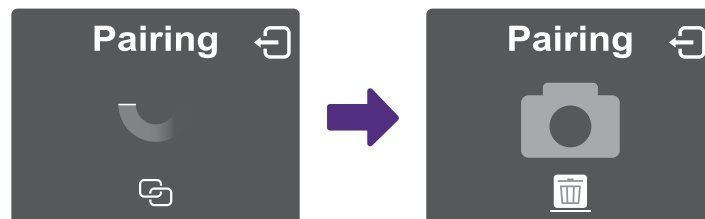

5. After pairing completes, press SET to return to the SET menu.
6. Press SET again to switch to viewfinder mode.



If you wish to quickly turn off pairing with your camera and switch on WLAN pairing to your mobile device, press and hold PHOTO and VIDEO together.





Live view

After your camera and watch are paired, live view appears on the watch screen when selecting viewfinder. You can then use this watch as a remote control to record videos or take photos.

Press **MODE/SLEEP** to switch to viewfinder mode. Aim your camera at your object, and then use your watch screen to preview your object.



Live view icon

Live view icon (Color)	Meaning
 (Orange)	The internal or the microSD card storage is full.
 (Blue)	The camera is recording.
 (Gray)	The watch is in standby mode (already connected to your camera).
 (Black)	The watch is disconnected from your camera.

- To take a photo, press **PHOTO**.
- To record a video, press **VIDEO** to start/stop recording.
- To take photos while recording a video, simply press **PHOTO**. The photo resolution will be the same as the video resolution.

Use the BenQ 4G Live Cam app

Features

The BenQ 4G Live Cam app is used to control your camera, including live preview on your mobile device (tablet or phone) when capturing photos/videos, reading your messages, logging into your Google account to enable live streaming videos to YouTube and setting up your camera.

Operating system requirements

- iOS 7 or later on iPhone 5 or later
- Android OS 4.3 or later



Operations, screen images and icons described in the following sections about using the app are written based on using an Android phone or tablet. If you are using an iOS phone or tablet, part of the user interface and operations may be different.

Install the app

1. Search for and download the BenQ 4G Live Cam app from the APP Store (for iOS) or the Google Play™ store (for Android OS) on your mobile device.
2. Install the app.

Set up the app



- The network data of your camera is turned on by default. If the data is turned off, please refer to “[Network](#)” on [page 47](#) to enable network data transmission before pairing.
- Your camera is set to mobile pairing by default. If you have previously changed this to watch pairing, follow the steps below to switch back to mobile.

A. On your camera

1. Press  > the Pairing mode > press .



2. Press  > **MOBILE** > press .



B. On your mobile device

1. Turn on its WLAN setting.

2. Select “BenQ QC1 XXXXX” on the WLAN network list.

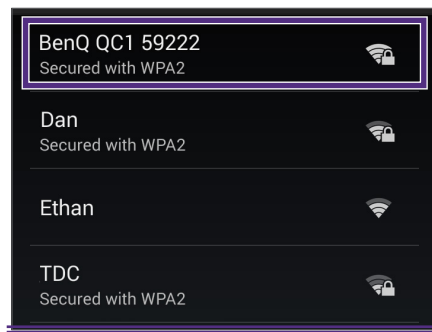

XXXXXX indicates the last 5 digits of your camera's IMEI number.

3. Enter the default password (00000000) and touch “Connect”.

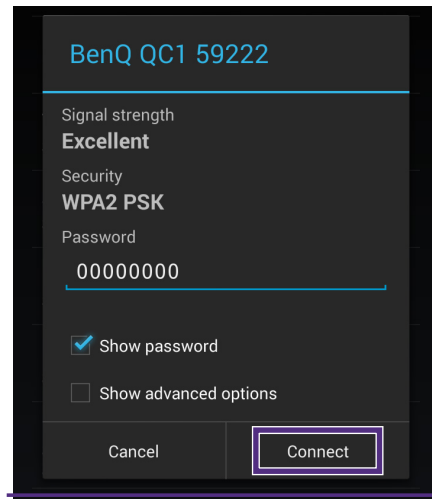

When the status bar at the top shows , your mobile device's WLAN connection is successful.



If you have performed the steps above and pairing does not start, please refer to [“Troubleshoot” on page 58](#).



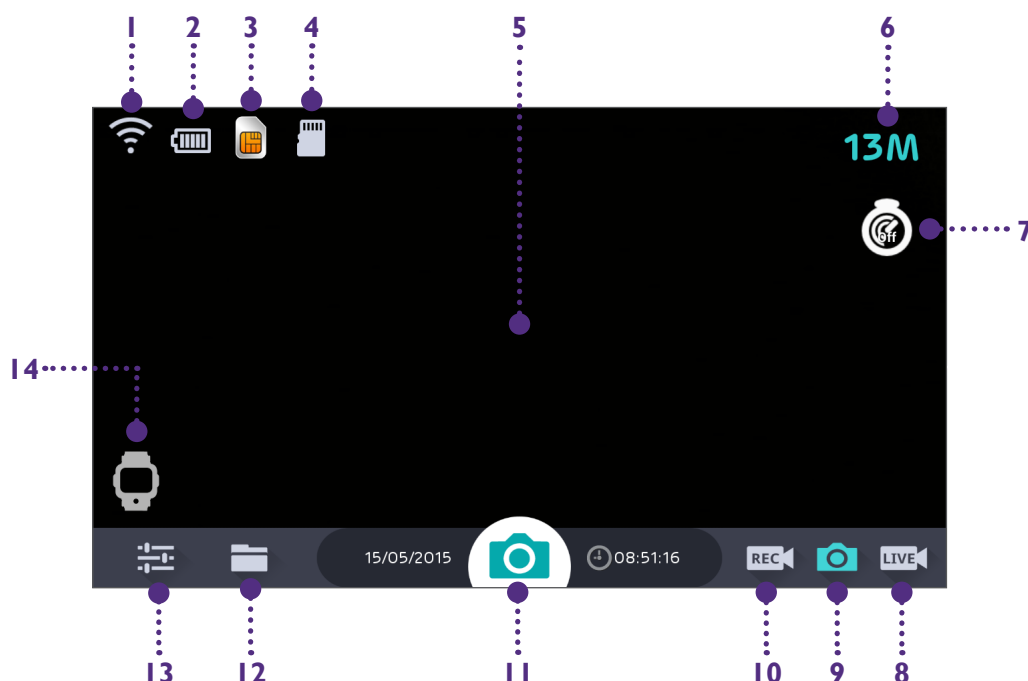

Initiate the app

On your mobile device, touch  to start the app.

Main screen overview



No.	Meaning
1	WLAN signal strength of the camera
2	Camera battery level
3	Nano-SIM card status of the camera
4	MicroSD card status of the camera
5	Preview screen
6	Photo/Video resolution
7	Select photo/video mode types
8	Live streaming mode
9	Photo mode
10	Video mode
11	Shutter
12	Manage photos/videos captured
13	Settings
14	Connect watch

- Touch mode icons  /  /  to enter Video/Photo/Live streaming modes.
- Touch Shutter to take photos or start/stop recording videos.
- To set up your camera or manage your account, touch .
- To quickly turn off pairing with your camera and switch on WLAN pairing to the Live-view RC watch, touch .



To read your messages or set up your account, a valid nano-SIM card must be inserted in your camera (please refer to [“Insert a nano-SIM card” on page 13](#)).

Set up your account to live stream to YouTube

-
- Before setting up your account for live streaming, ensure that:
 - ✓ You have a valid Google account and a YouTube channel of your own. For information on creating your Google account and YouTube channel, visit <https://support.google.com/accounts> and <https://support.google.com/youtube>.
 - ✓ Your camera is connected to the 3G/4G network.
 - ✓ You have paired your mobile device to your camera (refer to “Set up the app” on page 38).
 - Using mobile data connection may cause additional charges for data services. Contact your mobile service provider to check details of your data tariff plan.
-

1. In the main screen of the app, touch  to display the **SETTINGS** screen.

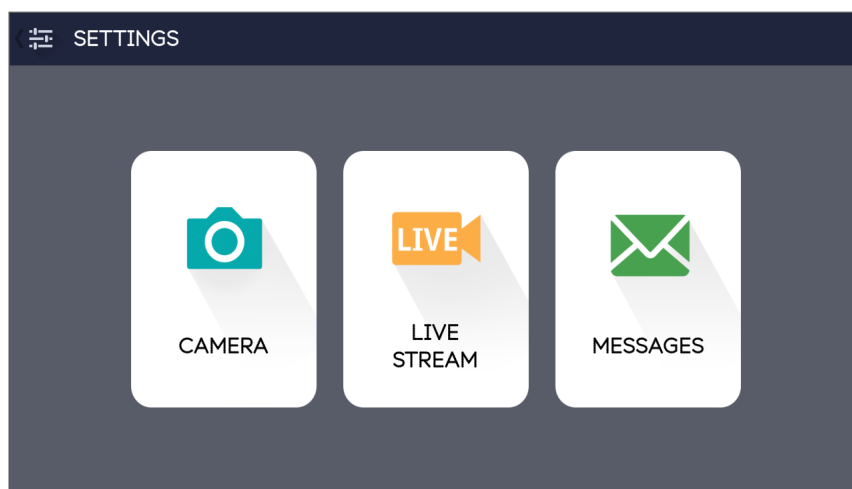

2. Touch **LIVE STREAM > YouTube > Sign in**. Enter your Google credentials and follow the steps on screen to complete authentication.



-
- You only have to set up your Google account for live streaming for the first time. Without logging out, the app remembers your account information.
-

Read your messages

1. In the main screen of the app, touch  to display the **SETTINGS** screen.



2. Touch **MESSAGES**.

3. Touch to read a message.

-  : Unread message
-  : Read message

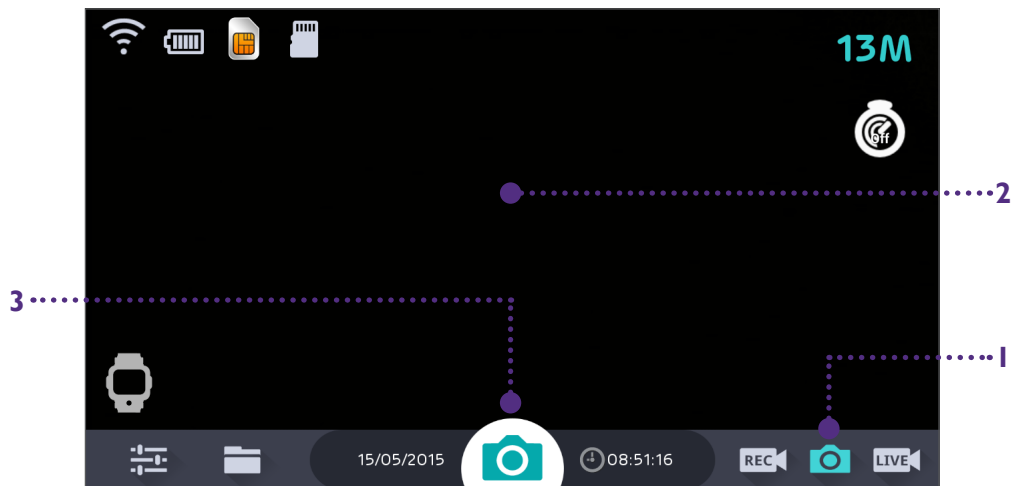
Take photos



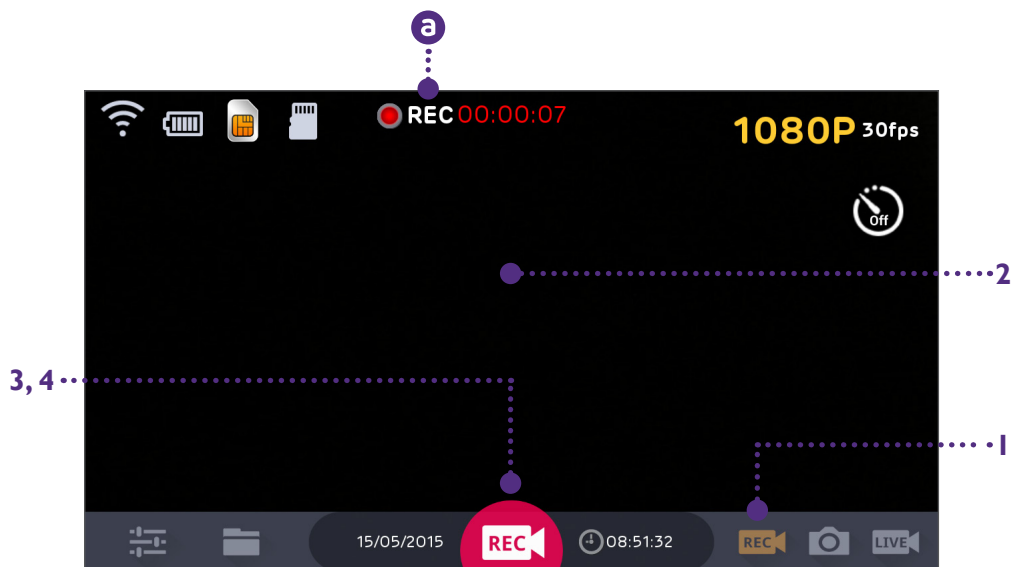

1. On your mobile device, touch  in the main screen of the app to enter the Photo mode.
2. Aim your camera at your object, which will be shown on the preview screen of your mobile device.
3. Back in the app, touch  to take a photo.

Record videos







1. On your mobile device, touch  in the main screen of the app to enter the Video mode.
2. Aim your camera at your object, which will be shown on the preview screen of your mobile device.

3. Back in the app, touch  to start recording. The REC icon turns red, and  displays at the top, indicating the elapsed time of the current recording **a**.
4. Touch  again to stop recording.

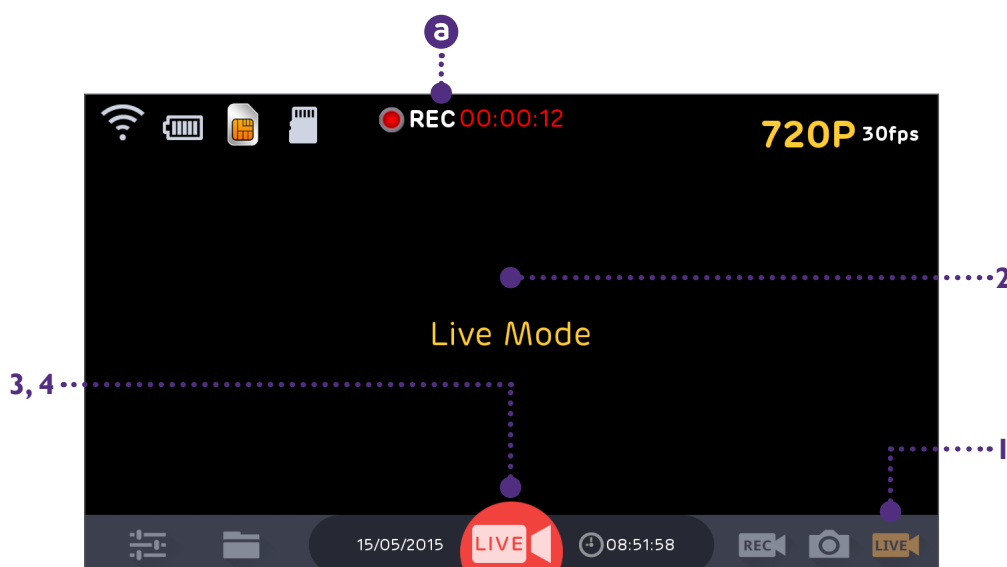
Live stream videos to YouTube

-
- If you are using this function for the first time, you have to set up and log into your Google account first. For detailed instructions, please refer to [“Set up your account to live stream to YouTube” on page 41](#).
 - Each time before live streaming a video to YouTube, you must enable network data connection, stay connected to the 3G/4G network, and have at least 100 MB of storage space available either on the camera or the microSD card for the camera. Live streaming over a 4G network will provide the best experience.
 - Each time you live stream a video to YouTube, ensure that the live stream lasts longer than 30 seconds.
-



1. On your mobile device, touch  in the main screen of the app to enter the Live streaming mode.
2. Aim your camera at your object, which will be shown on the preview screen of your mobile device.
3. Back in the app, touch  to start live streaming. The LIVE icon turns red, and  displays at the top, indicating the elapsed time since live stream began **a**.

-
- The preview screen goes black during live streaming.
-

4. Touch  again to stop live streaming. Your camera will save a copy of the streaming video to the internal or microSD card drive as well.



You need to have at least 100 MB of storage space available either on the camera or the microSD card for the camera to live stream a video to YouTube as well as save a copy of your streaming video.

Share live streaming videos

When you live stream a video to YouTube, other people can watch your live video in real time from your YouTube channel, based on the privacy settings of your videos. You can also notify your friends on Facebook and share the video with them by performing the following steps.



You need to have a valid Facebook account before sharing live streaming videos on Facebook. For information on creating a Facebook account, visit <https://www.facebook.com/help>.

1. Search for and download the Facebook app from the APP Store (for iOS) or the Google Play™ store (for Android OS) on your mobile device.
2. In the main screen of the app, touch  to display the **SETTINGS** screen.
3. Touch **LIVE STREAM > Facebook > Sign in**. Enter your Facebook credentials and follow the steps on screen to complete authentication.



You only have to set up your Facebook account for live streaming for the first time. Without logging out, the app remembers your account information.

4. The next time you start live streaming using your camera, the YouTube page link to your live streaming will be posted to your Facebook Page, notifying your friends on Facebook. Simply invite your friends to click on the link so they can watch your live video in real time.

Replay live streaming videos

When you live stream a video to YouTube, a copy of this recording will be saved. You can later use the BenQ 4G Live Cam app to watch a replay of the that recording. For detailed instructions, please refer to [“Manage photos and videos” on page 45](#).

Manage photos and videos

1. In the main screen of the app, touch  to display the following screen.

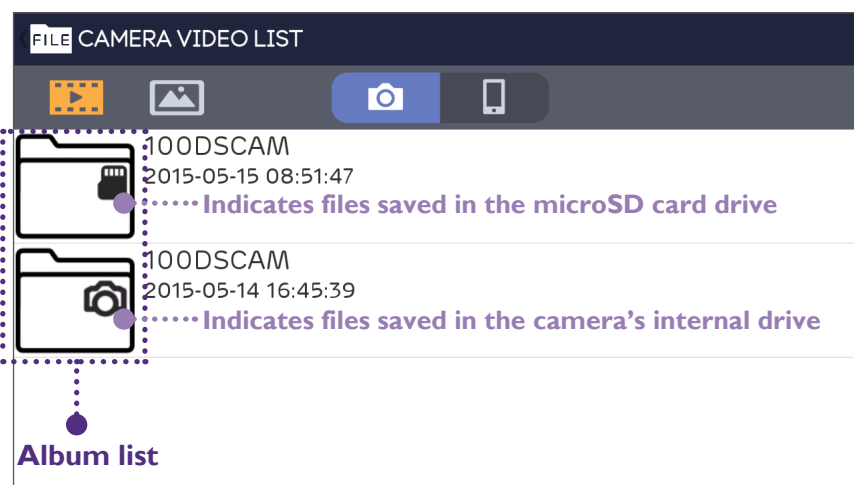



2. Touch  to select your camera as the file source.

3. To view videos or photos captured, touch  or .

4. Touch an album from the album list, and then scroll and touch a desired video or photo thumbnail. The selected video or photo plays back or displays in full screen.

5. Touch these action icons to manage your video or photo:

- : Delete the file.
- : Share the file by available apps.
- : Download the file to your mobile device's internal memory.



After downloading files to your mobile device, you can play back these files on your mobile device without being paired to the camera. To view the downloaded files, touch .

Set up your camera

You can use the BenQ 4G Live Cam app to set up your camera. During setup, your camera and the mobile device must remain paired.

1. In the main screen of the app, touch  to display the **SETTINGS** screen.

2. Touch **CAMERA**.

3. Touch the setting you wish to adjust, and touch to select your preferred option from the popup menu.



Except changing WLAN password, all of these camera settings can be found in your camera's Settings mode. To learn more about each setting, please refer to ["Use your 4G Connected Cam" on page 23](#).

Change the WLAN password

1. In the main screen of the app, touch  > **CAMERA** > **Change WLAN password**.
2. Enter the current WLAN password (default: 00000000), and touch **OK**.
3. Enter the new password, and touch **OK**.
4. Enter the same new password again for confirmation, and then touch **OK**.



- After changing the WLAN password, your mobile device will automatically be disconnected from the camera. Turn on your mobile device's WLAN setting, select "BenQ QCI XXXXX" and then touch "Forget". Select "BenQ QCI XXXXX" again from the WLAN list, touch "Connect" and then enter your new WLAN password to re-pair your device with the camera (please refer to ["Set up the app" on page 38](#).)
- If you forget your WLAN password, you can use the camera to reset the password to default. For detailed instructions, please refer to ["Password" on page 53](#).

Transfer camera files to a computer

1. With the battery installed in your camera, insert the smaller end of the USB cable into your camera's micro USB port.
2. Insert the larger end of the USB cable into your computer's USB port.
3. On your computer, your camera is detected as a media device. Click on the device or select an action from the data transfer window that appears. Copy or move your camera files to the computer.



When a microSD card is inserted into your camera, the microSD card and your camera's internal storage are mounted as two drives on your computer. You can click on the drive where you want to transfer files between your camera and the computer.







Do not interrupt USB connection during data access process. Stored data may be lost or damaged.

Set up your 4G Connected Cam

Press  > the Settings mode > press .



- Press  to go through menu options > press .
- To return to the previous menu level, press  > **EXIT** > press .

Network

This function is switched on by default and allows you to stream live videos and to share your camera's mobile data connection as a portable WLAN hotspot. However, more battery power may be consumed. To turn off this function, perform the following steps.

1. Press  > **SETUP** > press .





2. Press  > **NETWORK** > press .



3. Press  > **DATA** > press .



4. Press  > **OFF** > press .



Roam

Turn on this function to enable international data roaming when travelling abroad.



Extra charges may occur. Contact your mobile service provider for information about availability and fees.

1. Press > **SETUP** > press .

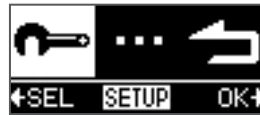

2. Press > **NETWORK** > press .



3. Press > **ROAMING** > press .



4. Press > **ON** > press .



GPS

Enable this function to let your camera collect your location data from the mobile network, and tag your location to the photos you take.

If you have privacy or security concerns over your location data, disable location data collection.

1. Press > **SETUP** > press .



2. Press > **GPS** > press .



3. Press > **ON** > press .



Video resolution

To set the video resolution:

1. Press  > **SETUP** > press .

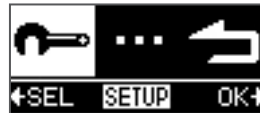

2. Press  > **VIDEO** > press .



- To set the video resolution and quality when recording in Live streaming mode:

Press  > **LIVE** > press .



To set video resolution, press  > **RESOLUTE** > press ; to set video quality, press  > **QUALITY** > press .

- To set the video resolution when recording in Video mode (for video recording to the internal or the microSD card drive):

Press  > **LOCAL** > press .



3. Press  to go through the options > press .

Photo resolution



To set the photo resolution:

1. Press  > **SETUP** > press .



2. Press  > **PHOTO** > press .



3. Press  to go through the resolution options > press .

Volume

Adjust or turn off the camera sounds.

1. Press  > **MORE** > press .



2. Press  > **VOLUME** > press .



3. Press  to go through the options > press .

Brightness

Adjust the screen brightness.

1. Press  > **MORE** > press .



2. Press  > **BRIGHT** > press .



3. Press  to go through the options > press .

Auto power off



Enable this function to power off your camera automatically after a set period of inactivity.

1. Press  > **MORE** > press .



2. Press  > **POWEROFF** > press .



3. Press  to go through the options > press .

Orientation

Set the screen orientation. This is useful when you mount the camera upside down.

1. Press  > **MORE** > press .



2. Press  > **UP/DOWN** > press .



3. Press  to select your preferred orientation > press .



Loop



Enable this function to record videos continuously and saved in separate files with specified time segments. Once the internal or the microSD card storage is full, the saved video loops will be overwritten with new ones until you manually stop loop recording.

1. Press  > **MORE** > press .



2. Press  > **LOOP** > press .



3. Press  > **ON** > press .



Delete

 This operation is irreversible. Consider backing up photos/videos captured to your computer or a secondary storage device first.

1. Press  > **MORE** > press .



2. Press  > **DELETE** > press .



3. To delete the file(s) last captured, press  > **LAST** > press ; to delete all files, press  > **ALL** > press .

Format

Performing this action will erase all your stored data from your camera's internal storage or the microSD card storage.

 This operation is irreversible. Consider backing up photos/videos captured to your computer or a secondary storage device first.

1. Press  > **MORE** > press .



2. Press  > **DELETE** > press .



3. Press  > **FORMAT** > press .



Update your camera

When your camera has a mobile data connection, it automatically checks for system updates and notifies you by displaying  on the notification area of your camera screen.

 Before updating your camera, ensure that your camera has sufficient space to download the update package, you have backed up your camera's important data to your computer or a secondary storage device, and your camera has a strong mobile data connection.

1. Press  > **MORE** > press .



2. Press  > **UPDATE** > press .

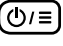
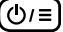

3. Press  to start downloading the update package.
4. Press  again to update the system, and then your camera automatically restarts.

Password

If you have changed or forgotten the WLAN password for your BenQ 4G Live Cam app, you can use this option to reset it back to default.

1. Press  > **MORE** > press .



2. Press  > **PASSWORD** > press .



3. Press  > **RESET** > press .



 To change your camera's WLAN password, use the BenQ 4G Live Cam app. For detailed instructions, please refer to ["Change the WLAN password" on page 46](#).

Reset your camera

Performing this action will restore your camera to its factory state and erase all your user settings from your camera's internal storage. However, whom you have chosen to pair the camera to remains unchanged.

 This operation is irreversible.

1. Press  > **MORE** > press .



2. Press  > **RESET** > press .



3. Press  to confirm and reset your camera.

Check your camera's firmware version

1. Press  > **MORE** > press .



2. Press  > **VERSION** > press .



Set up the Live-view RC watch

Press PREV repeatedly to go through the following functions.



Stopwatch

1. Press PREV repeatedly to display the stopwatch.
2. Press VIDEO to start/pause the stopwatch.

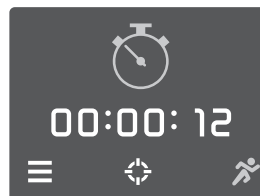

3. To add laps while the stopwatch is running, press NEXT.
4. To reset the stopwatch, press VIDEO to pause the stopwatch, and then press SET.

Countdown timer

1. Press PREV repeatedly to display the countdown timer.
2. Press VIDEO to start/pause the countdown with default end time.
 - To set the countdown time, press and hold SET until the hour starts to flash.



Press NEXT repeatedly to select the desired field, and then press VIDEO or PHOTO to adjust the value. Press SET to confirm.

3. To reset the timer, press VIDEO to pause the timer, and then press SET.

Alarm clock

1. Press PREV repeatedly to display the alarm clock.
2. To activate the alarm, press VIDEO to select ON.
3. To set the alarm time, press and hold SET until the hour starts to flash.



Press NEXT repeatedly to select the desired field, and then press VIDEO or PHOTO to adjust the value. Press SET to confirm selection.

Auto power off

1. Press MODE/SLEEP to switch to viewfinder mode. Then, press and hold SET to display the SET menu.
2. Press NEXT repeatedly to display the **AutoOff** screen, and then press VIDEO.
3. Press NEXT repeatedly to select the desired inactivity period of time before turning off the screen. Press VIDEO to confirm selection.

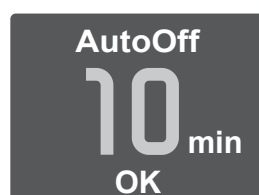

Sound

1. Press MODE/SLEEP to switch to viewfinder mode. Then, press and hold SET to display the SET menu.
2. Press NEXT repeatedly to display the **Sound** screen, and then press VIDEO.
3. Press PREV or NEXT to enable or disable the sound, and then press VIDEO to confirm selection.

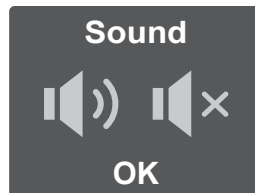

Brightness





1. Press MODE/SLEEP to switch to viewfinder mode, and then press and hold SET to display the SET menu.
2. Press NEXT repeatedly to display the **Bright** screen, and then press VIDEO.
3. Press NEXT or PREV repeatedly to adjust screen brightness, and then press VIDEO to confirm selection.





Troubleshoot

Frequently asked questions and common problems that may occur while using your camera are explained in this section. If a problem persists and you can't resolve it, contact your place of purchase or our service center.

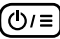
Power/battery

-  My camera/watch does not switch on or charge.
-  If the battery is fully discharged, the camera/watch cannot be switched on immediately when the power adapter is connected. You must allow an empty battery to charge for a period of time (approximately 5 minutes) before you can switch on the camera/watch.
-  How can I save battery power?
-  Check and perform the following actions:
 - Press and hold  when not in use.
 - Mute the sound of your camera.
 - Switch off network data connection.

Nano-SIM card

-  The nano-SIM card cannot be detected.
-  Check and perform the following actions:
 - Ensure that you have fully inserted the nano-SIM card into the card slot in the correct direction. Please refer to [“Insert a nano-SIM card” on page 13](#).
 - Your nano-SIM card is protected by a PIN code. Use a mobile phone to unlock and disable the PIN code.







Pair

 I have trouble pairing my camera with the Live-view RC watch.

 Check and perform the following actions:

- The network data of your camera is switched on (please refer to [“Network” on page 47](#)).
- You have selected **WATCH** in the camera's Pairing mode.
- Follow the steps below to reconnect your watch with your camera.

1. On your camera:

- a. Press  > the Settings mode > press .
- b. Press  > **SETUP** > press .
- c. Press  > **CONNECT** > press .

2. On your Live-view RC watch:

- a. Press MODE/SLEEP to switch to viewfinder mode. Then, press and hold SET to display the SET menu.
- b. Press NEXT repeatedly to display the **Pairing** screen, and then press VIDEO.
- c. Press VIDEO to break current pairing.

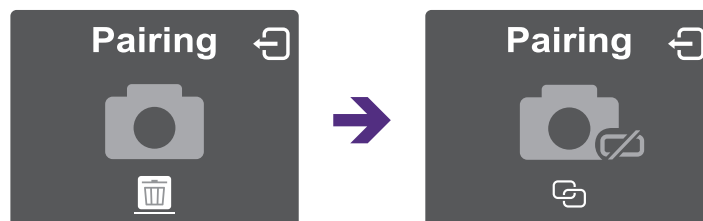

- d. Press VIDEO again to start a new pairing.

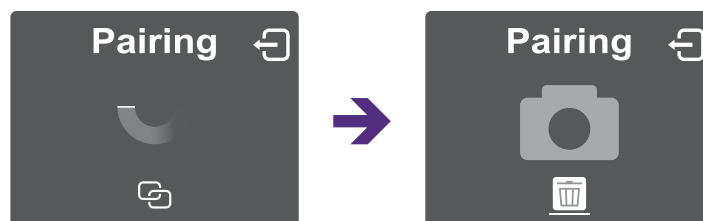



 I have trouble pairing my camera with my mobile device.

 Check and perform the following actions:

- The network data of your camera is switched on (please refer to “[Network](#)” on [page 47](#)).
- You have selected **MOBILE** in the camera’s Pairing mode.
- The WLAN connection icon appears on your mobile device’s status bar and shows strong signals. If the access point name of your camera does not appear on your mobile device’s WLAN list, touch “Refresh” on your mobile device.

Live streaming

 I cannot find my live streaming videos on YouTube.

 Firstly, ensure that each live streaming video lasts longer than 30 seconds.

Secondly, please perform the following operations:

- Reload the web page.
- Re-open the link to the live streaming video later.

Appendix

Specifications



Specifications are subject to change without prior notice. For most up-to-date information, please visit <http://www.BenQ.com>.

Item		Specifications
Core Chip		Qualcomm® Snapdragon™ 400, Quad-core 32-bit (1.2 GHz)
Display		0.83" OLED
Image Sensor		1/2.3" 13M CMOS sensor
Objective		F 2.8 (7 elements aspherical lenses)
Functional Sensor		GPS
Interface		MicroSD Card
		Micro USB
Microphone		Mono microphone
Internal Memory		4GB eMMC
Video	Resolution	Local: 1080P (16:9): 24, 30 fps 720P (16:9): 30, 60 fps 480P (16:9): 30, 60, 120 fps
		Streaming: 720P (16:9): 24, 30 fps 480P (16:9): 24, 30 fps
	Format	H.264 MP4
	Time Lapse	1, 3, 5, 10, 30, 60 seconds
Photo	Resolution	Megapixels +fov: 2.4M, 3M, 10M, 13M
	Format	JPEG (EXIF 2.3), DCF
	Burst	7/1 Photos/sec
	Self-timer	2, 10 seconds
Network		LTE: Band 3 (1800 MHz), 7 (2600 MHz), 20 (800 MHz) UMTS: 900/2100 MHz
SIM Card Type		Nano-SIM
Advanced Feature		WLAN
		RF Remote
		Auto White Balance
		Looping Video
		Auto Power Off: 10, 30 minutes
Dimension		59.2(W) X 42.7(H) X 51.3(D) mm (with lens)
Weight		128 g (with battery)
Power Source		Rechargeable Li-ion battery (2260 mAh)

RF exposure

CE SAR compliance

This camera meets the EU requirements (1999/519/EC) on the limitation of exposure of the general public to electromagnetic fields by way of health protection.

The limits are part of extensive recommendations for the protection of the general public. These recommendations have been developed and checked by independent scientific organizations through regular and thorough evaluations of scientific studies. The unit of measurement for the European Council's recommended limit for mobile devices is the "Specific Absorption Rate" (SAR), and the SAR limit is 2.0 W/kg averaged over 10 gram of tissue. It meets the requirements of the International Commission on Non-ionizing Radiation Protection (ICNIRP).

For body worn operation, this camera has been tested and meets the ICNIRP exposure guidelines and the European Standard EN 50566 and EN 62209-2, for use with dedicated accessories. Use of other accessories which contain metals may not ensure compliance with ICNIRP exposure guidelines.

SAR is measured with the device at a separation of 10 mm to the body, while transmitting at the highest certified output power level in all frequency bands of the device.

The maximum SAR value is 0.845 W/kg over 10 gram of tissue.

SAR is measured when the camera is at its highest transmitting power. However, the actual SAR of your camera is usually below the test level. This is because your camera is designed to use the minimum power necessary to upload videos.

Caution

Risk of explosion if battery is replaced by an incorrect type. Dispose of used batteries according to the instructions.

Limit your exposure to radio frequency (RF)

- Keep your camera at least 10 mm away from your body while uploading videos.
- You can find more information from the WHO fact sheet N°193 on the WHO home page at: <http://www.who.int/mediacenter/factsheets/fs193/en>

Declaration of Conformity

We, BenQ Corporation,

Address: 16 Jihu Road, Neihu, Taipei 114, Taiwan

Declare under our sole responsibility that the product:

Model: 4GEE ACTION CAM/QCI

Intended use: Camera WCDMA/LTE800/LTE1800/LTE2600/IEEE 802.11b/g/n

To which this declaration relates, is in conformity with the following standards and/or other normative documents:

1. Health (Article 3.1(a) of the R&TTE Directive)
 - EN 62311:2008, EN 62209-2:2010, EN 50566:2013/AC:2014
2. Safety (Article 3.1(a) of the R&TTE Directive)
 - EN 60950-1:2006/A11:2009+A1:2010+A12:2011
3. Electromagnetic compatibility (Article 3.1 (b) of the R&TTE Directive)
 - EN 301 489-1 V1.9.2, EN 301 489-3 V1.6.1
 - EN 301 489-17 V2.2.1, EN 301 489-24 V1.5.1
 - EN 55022:2010/AC:2011 Class B, EN 55024:2010
 - EN 61000-3-2:2006/A1:2009/A2:2009, EN 61000-3-3:2008
4. Radio frequency spectrum usage (Article 3.2 of the R&TTE Directive)
 - EN 301 908-1 V6.2.1, EN 301 908-2 V6.2.1, EN 301 908-13 V6.2.1
 - EN 300 328 V1.8.1
 - EN 300 440-1 V1.6.1, EN 300 440-2 V1.4.1
5. RoHS Directive (2011/65/EU)
 - EU 50581:2012

We hereby declare that the above named product is in conformance to all the essential requirements of the Directives:

R&TTE Directive (1999/5/EC), RoHS Directive (2011/65/EU)

All the reports of the applied standards under R&TTE Directive have the Positive Opinion of Notified Body:

CETECOM, Untertuerkheimer Str. 6 - 10 66117 Saarbruecken

Identification mark: **C €0682**

The technical documentation relevant to the above equipment will be held at:

BenQ Corporation

16 Jihu Road, Neihu, Taipei 114, Taiwan

